



# KMA STATE RIFLE And SHOTGUN SHOOT

June 14<sup>TH</sup>- 16<sup>th</sup>, 2024

Overbrook, KS (see map on back)

Hosted by **First Santa Fe Trail Plainsmen MLC**

Registration begins at 11 am on Friday and 8 am on Sat. and SUN.

Shooting from 9-4 NO relay started after noon on Sunday.

Rifle and Pistol will be Woods Walk events, the shotgun will be Clay Bird

Registration \$5.00, camp Fee \$5.00

Relay cost.

Rifle \$5.00,

Pistol \$5.00.

Tomahawk and Knife. \$3.00

Unsighted Smoothbore, \$3.00, shooting for medals only.

Inline \$3.00, shooting for medals only.

Bench-Rest \$3.00, shooting for medals only.

Shotgun \$15.00

Categories:

The shotgun match will be a 35-shot match with 15 shots Trap and 20 shots 5 stand.

Men's Rifle                      Men's Pistol

Women's Rifle                Women's Pistol

Youth Rifle                    Hawk/Knife

Smooth bore    Bench Rest

Inline

*Top Gun: total scores of  
Rifle, Pistol,  
Tomahawk/Knife and  
Shotgun*

Rifle loaded from the bag; Pistol may be loaded at bench. All Rifle shots are offhand.

Pistol may be shot with a 2-hand hold. Tiebreaker target will be shot on a card. Prizes and awards will be made after last relay.

Round Ball only. The shotgun awards will be after the shotgun match on Saturday.

NMLRA rules apply.

All are welcome to camp. The range will be open for camp setup on Thursday the 13<sup>th</sup>. Firewood provided. Bring your own water. \$5.00 Camp Fee awarded back as prizes for period correct camps.

*For more information contact Phil Mott at [mott@satelephone.com](mailto:mott@satelephone.com) or  
620-341-7165*

# First Santa Fe Trails Plainsmen Overbrook, KS

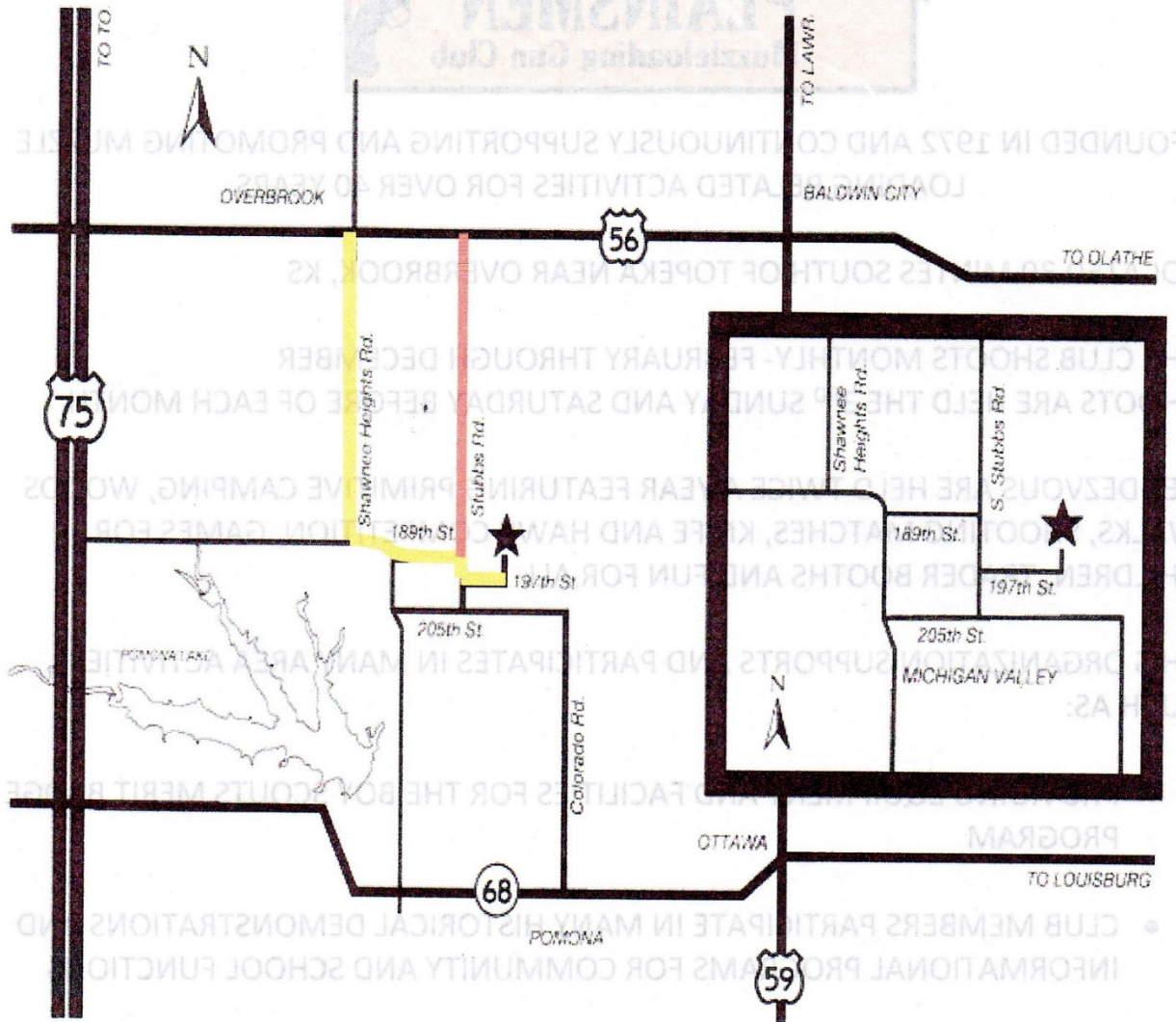

Drive south on Maple St (the main street that goes through downtown). Outside of the city limits it is Shawnee Heights Road. The road will curve left and then right; at the second curve turn left onto 186<sup>th</sup> Street. Continue to Stubbs Road, turn right. Continue to 197<sup>th</sup>, turn left. The drive to the range is about  $\frac{3}{4}$  of a mile down the road; turn left into the drive.

Alternate route: Go south on Stubbs Road to 197<sup>th</sup>, turn left. The drive to the range is about  $\frac{3}{4}$  of a miles down the road; turn left into the drive.

**Look for signs pointing the way to the range.**